



Connector and cable systems

Connecting to new technology

PRODUCT CATALOG

Version:2022.A1



Made in China
www.bexkomconnectors.com



Connecting to new technology

Founded in 2016, Bexkom connector and cable systems is headquartered in Shenzhen, China. It is a well-known brand in the design and manufacture of connector solutions.

Bexkom are always adhered to its unshakable core values, such as quality, innovation, globalization, at the same time, we desire health, peace, equality and freedom.

The founder of Bexkom and some of its team members have nearly 20 years of experience in the connector industry. We have our own core key technologies such as connector development and design, mold, reliability testing, over moulding, CNC, etc. The main supplier of more than 600 customers located in more than 30 countries, products are widely used in medical equipment, military, industrial testing, testing and measurement, radio and television, communications , new energy and other fields.

We received more than 30 special customized new projects from customers every year.

We have a special sample team and a sample production line, which can deliver samples to customers within 2 weeks in most cases.

The shareholder team of Bexkom has reached an agreement on the experience and concept to ensure that the huge investment in product research and development every year is ahead of the peers, we has been committed to the innovation of product technology, at the same time, we have also been committed to the concept of fast delivery.

Our vision is to be a leader in new technology connector manufacturer.

We had obtained ISO9001, ISO13485 certification, and our products comply with ROHs, Reach, CE, UL and other standards. At the same time, we can provide certification tests for customers' products and obtain certificates according to customer requirements.

We ensures a safe environment for employees and visitors, we encourages and committed to conducting business in ethical manner and responsible. Our comprehensive management system ensures product quality, environment, health and safety, and strictly follows rules to meet industry standards.

Table of Contents

Introduction03
Technical Characteristics.....	.04
Model Number Rule05
B Series Models (IP50).....	.07
K Series Models (IP68).....	.25
S Series Models (IP50).....	.37
B K F S Series Tooling.....	.44
P Series Models (IP50 IP64).....	.58

For more than 6 years, Bexkom has designed, manufactured, and distributed high performance connectors and cable assembly solutions. Known for their quality, ruggedness and cost effective, our products prove to be reliable in the most demanding environments. For a wide range of applications and environments the family of Bexkom connectors are the ideal match for the third party connector. The line up is optimized to provide the best performance fit and value for money. Bexkom provides complete, high quality turnkey solutions – connectors, cable assemblies and overmolding – all from one supplier.

For several reasons, only the most popular B.S.K.F.A.U.P connector series and the appropriate connectors are mentioned in this catalogue. Connectors series such as M/T/C and other series etc. belong to the extended product range.

The selection within these series however is rather limited. For more information, please contact our sales department.

Technical Characteristics

Most metallic components in general are manufactured in brass, and plastic housing are manufactured in PSU/PC. However, bronze or beryllium copper are used where good elasticity is required. Depending upon the application, these parts have electrolytic nickel-gold or nickel-chrome plating. These parts can also be manufactured in stainless steel and aluminum.

	B/K/S series	A series	U series	F series	P series
Shell Materials	brass	aluminum/brass	brass	brass	plastic
Insulator Materials	PPS/PEEK	PPS/PEEK	PPS/PEEK	PPS/PEEK	PPS/PEEK
Shielding	> 75 dB(10MHz)	> 90 dB(10MHz)	>90 dB(10MHz)	>90 dB(10MHz)	-
Current Rating	Up to 30A	Up to 10A	Up to 10A	Up to 30A	Up to 30A
Temperature Range	-55°C /+250°C	-55°C /+250°C	-55°C /+250°C	-55°C /+250°C	-25°C /+200°C
Endurance	>5000 cycles	>5000 cycles	>5000 cycles	>5000 cycles	>2000 cycles
Protection Index	IP50	IP68	IP68	IP68	IP50 IP65
Contact number	40	9	13	30	26

Bexkom offers a series of connector product line for almost any application, from medical equipment to test and measurement instrumentation. We focus on delivering on time, low cost and on experience connectivity solutions that stand up to the toughest conditions, so you know you can rely on our service and on uncompromising quality in all environments.

Where and Why Bexkom Connectors

- Industrial and Automation
- Military and medical electronics
- Telecommunication
- Test and Measurement
- Quality aesthetics for more value added on the equipment
- Extremely fast and easy to play
- Space saving
- A thousand mating/unmating cycles

Key features & benefits

- Security of the push-pull self-latching system
- Easy blind mating in difficult-to-reach places
- High contact density in a small space
- Multicontact types 1 to 40 positions
- Keying system for connector alignment
- Compatible with the third party connectors
- Cost-effective solutions

Push-Pull Locking System

The locking of the plug into the receptacle is achieved by a simple axial push on the outer shell.

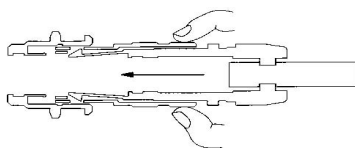

The locking of the plug into the receptacle is achieved by a simple axial push on the outer shell.

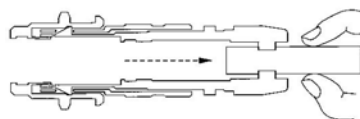

The locking of the plug into the receptacle is achieved by a simple axial push on the outer shell.

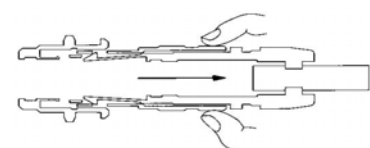

Model Number Rule (Plug)

Use this model number rule to identify products from their model number. When ordering, use a model number from the table in Ordering Information.

TFG G.0B07.CL AD.50 ZV

□□□ □ . □□□□ . □□□□ . □□□□ □□

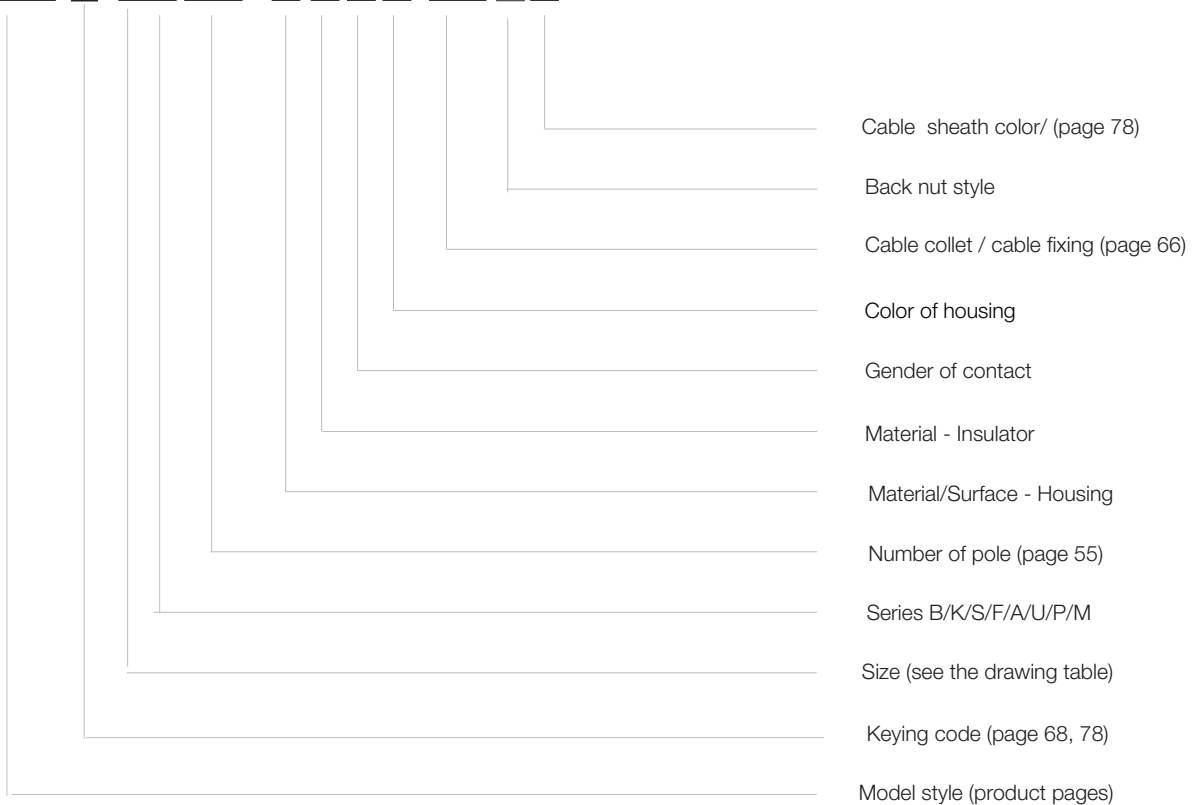

Material/Surface - Housing

C = Silver chromed plated
S = black chromed plated

Series

B K S

Material - Insulator

P = PPS
L = PEEK

Gender of Contact

A = male contact
L = female contact

Back Nut Style

0 = standard back nut
Z = back nut for fixing a bend relief

Examples:

B102-0B07-CM00-052S

Straight plug with 1 key (alpha=0) and rear nut for fitting a bend relief, 0B series, multicontact type with 7 contacts, outer shell in chrome-plated brass, PPS insulator, male solder contacts, cable collet for 5.0 mm diameter cable.

Model Number Legend (Socket)

Use this model number legend to identify products from their model number. When ordering, use a model number from the table in Ordering Information.

ZEGG .1B06. CLL

□ □ □ □ . □ □ □ □ . □ □ □ □ . □ □ □ □

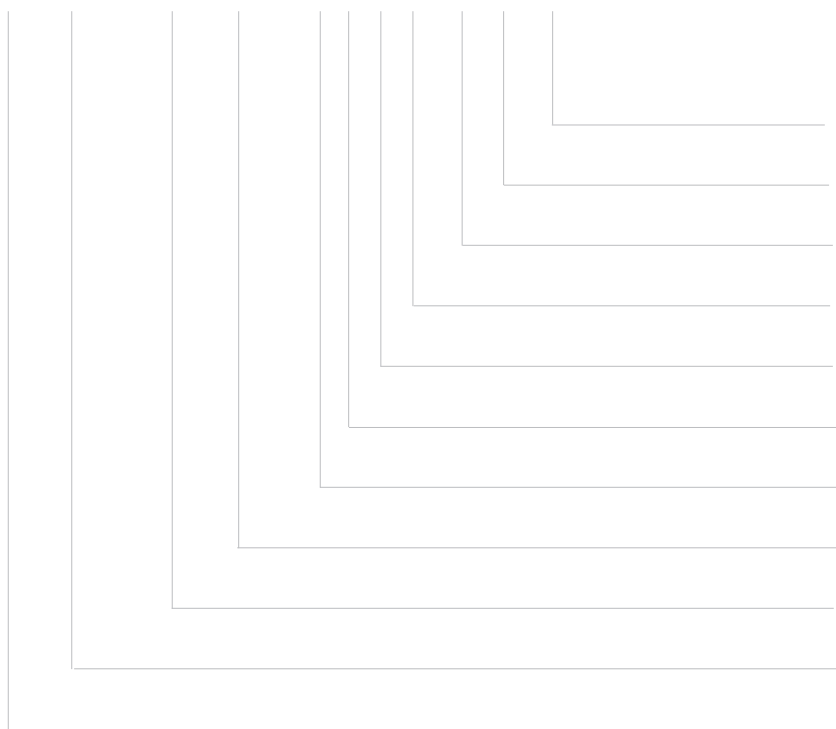

- Contact type for printed circuit
- Cable collet / cable fixing (page 66)
- Front nut color for plastic socket (page 78)
- Keying code (page 68, 78)
- Material - Insulator
- Gender of pole
- Material/Surface - Housing
- Number of pole (page 55)
- Size (see the drawing table)
- Model style (product pages)
- Series

Material/Surface - Housing

C = chromed plated
k = black chromed

Series

B K S F P

Material - Insulator

L = PPS
P = PEEK

Gender of Contact

A = male contact
L = female contact

Back Nut Style

0 = standard back nut
S = back nut for fixing a bend relief

Examples:

B401-0B07-CF00-0000

Fixed socket with 1 key (alpha=0), 0B series, multicontact type with 7 contacts, outer shell in chrome-plated brass, PPS insulator, female solder contacts.

B SERIES CONNECTORS

TFG

| b series

Straight plug with standard back nut

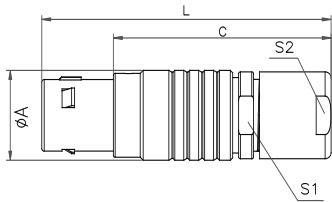

Reference		Dimensions (mm)					Availability	
Model	Size	A	L	C	S1	S2		
TFG	00	6.4	28.0	20.5	5.5	5.0	●	
TFG	0B	9.5	36.0	26.0	8.0	7.0	●	
TFG	1B	12.0	43.0	32.0	10.0	9.0	●	
TFG	2B	15.0	50.0	38.0	13.0	12.0	●	
TFG	3B	18.0	58.0	43.0	15.0	14.0	●	
TFG	4B	25.0	75.0	57.0	21.0	20.0	○	



Materials

Brass (chrome plated) shell and collet nut, nickel plated brass latch sleeve and mid pieces

Temperature range

-40°C / +200°C

Multicontact types 2 to 40 contacts

IP Index: IP50

TFG

| b series

Straight plug with back nut for fitting a bend relief

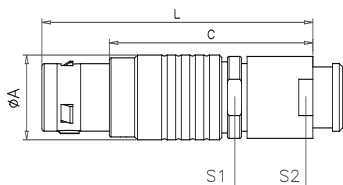

Reference		Dimensions (mm)					Availability	
Model	Size	A	L	C	S1	S2		
TFG	00	6.4	28.0	20.5	5.5	5.0	●	
TFG	0B	9.5	36.0	26.0	8.0	7.0	●	
TFG	1B	12.0	43.0	32.0	10.0	9.0	●	
TFG	2B	15.0	50.0	38.0	13.0	12.0	●	
TFG	3B	18.0	58.0	43.0	15.0	14.0	●	
TFG	4B	25.0	75.0	57.0	21.0	20.0	○	



Materials

Brass (chrome plated) shell and collet nut, nickel plated brass latch sleeve and mid pieces

Temperature range

-40°C / +200°C

Multicontact types 2 to 40 contacts

IP Index: IP50

TFP

I b series

Elbow (90°) plug with standard back nut

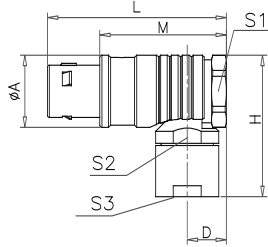

Reference		Dimensions (mm)								Availability	
Model	Size	A	D	H	L	M	S1	S2	S3		
TFP	00	7.7	5.2	18.0	24.5	16.5	7.0	5.0	5.5	○	
TFP	0B	11.0	6.5	23.0	30.0	20.0	9.0	7.0	8.0	●	
TFP	1B	13.5	8.0	28.0	36.0	25.0	11.0	9.0	10.0	●	
TFP	2B	16.5	9.0	34.0	41.5	29.5	14.0	12.0	13.0	●	
TFP	3B	19.0	10.0	37.0	50.0	35.0	17.0	14.0	15.0	○	
TFP	4B	26.0	15.0	52.0	67.0	49.0	22.0	20.0	21.0	○	



Materials

Brass (chrome plated) shell and collet nut, nickel plated brass latch sleeve and mid pieces

Temperature range

-40°C / +200°C

Multicontact types 2 to 40 contacts

IP Index: IP50

TFP

I b series

Elbow (90°) plug with back nut for fitting a bend relief

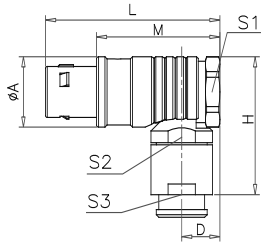

Reference		Dimensions (mm)								Availability	
Model	Size	A	D	H	L	M	S1	S2	S3		
TFP	00	7.7	5.2	18.0	24.5	16.5	7.0	5.0	5.5	○	
TFP	0B	11.0	6.5	23.0	30.0	20.0	9.0	7.0	8.0	●	
TFP	1B	13.5	8.0	28.0	36.0	25.0	11.0	9.0	10.0	●	
TFP	2B	16.5	9.0	34.0	41.5	29.5	14.0	12.0	13.0	●	
TFP	3B	19.0	10.0	37.0	50.0	35.0	17.0	14.0	15.0	○	
TFP	4B	26.0	15.0	52.0	67.0	49.0	22.0	20.0	21.0	○	



Materials

Brass (chrome plated) shell and collet nut, nickel plated brass latch sleeve and mid pieces

Temperature range

-40°C / +200°C

Multicontact types 2 to 40 contacts

IP Index: IP50

TFN

I b series

Straight plug with lanyard, standard back nut

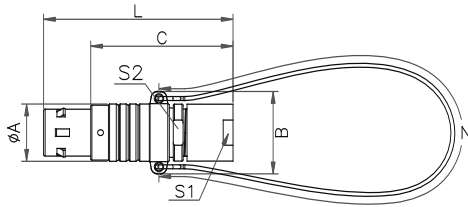

Reference		Dimensions (mm)							Availability	
Model	Size	A	B	L	C	N	S1	S2		
TFN	0B	9.2	15.8	34.0	24.0	140	8.0	7.0	○	
TFN	1B	12.0	18.0	41.0	30.0	150	10.0	9.0	●	
TFN	2B	15.0	21.0	49.0	36.0	160	13.0	12.0	●	
TFN	3B	18.0	25.0	58.0	43.0	190	15.0	14.0	○	
TFN	4B	25.0	35.0	75.0	57.0	230	21.0	20.0	○	

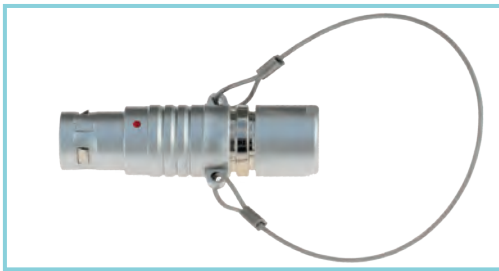

Materials

Brass (chrome plated) shell and collet nut, nickel plated brass latch sleeve and mid pieces

Temperature range

-40°C / +200°C

Multicontact types 2 to 40 contacts

IP Index: IP50

TFN

I b series

Straight plug with lanyard, back nut for fitting a bend relief

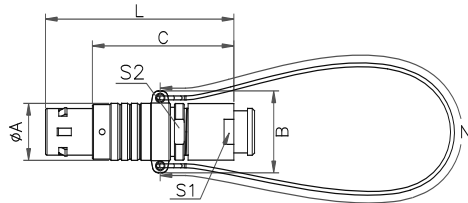

Reference		Dimensions (mm)							Availability	
Model	Size	A	B	L	C	N	S1	S2		
TFN	0B	9.2	15.8	34.0	24.0	140	8.0	7.0	○	
TFN	1B	12.0	18.0	41.0	30.0	150	10.0	9.0	●	
TFN	2B	15.0	21.0	49.0	36.0	160	13.0	12.0	●	
TFN	3B	18.0	25.0	58.0	43.0	190	15.0	14.0	○	
TFN	4B	25.0	35.0	75.0	57.0	230	21.0	20.0	○	

b series

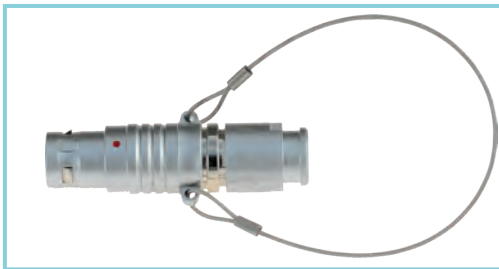

Materials

Brass (chrome plated) shell and collet nut, nickel plated brass latch sleeve and mid pieces

Temperature range

-40°C / +200°C

Multicontact types 2 to 40 contacts

IP Index: IP50

TFW

I b series

Fixed plug (back panel mounting)

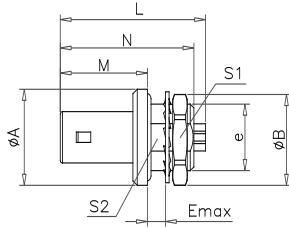

Reference		Dimensions (mm)									Availability
Model	Size	A	B	E	L	M	N	S1	S2	e	
TFW	00	8.0	10.3	2.4	18.1	9.0	15.2	6.3	9.0	M7x0.5	○
TFW	0B	10.0	12.5	3.3	20.8	11.2	18.4	8.2	11.0	M9x0.6	●
TFW	1B	14.0	16.0	6.5	25.2	12.5	22.6	10.5	14.0	M12X1.0	●
TFW	2B	18.0	19.5	6.8	28.7	13.8	25.4	15.3	17.0	M15x1.0	○
TFW	3B	22.0	25.2	7.6	32.1	17.0	29.1	16.5	22.0	M18X1.0	○



Materials

Brass (chrome plated) shell and collet nut, nickel plated brass latch sleeve and mid pieces

Temperature range

-40°C / +200°C

Multicontact types 2 to 40 contacts

IP Index: IP50

ZEG

I b series

Fixed socket (back panel mounting)

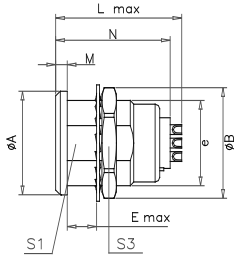

Reference		Dimensions (mm)									Availability
Model	Size	A	B	E	L	M	N	S1	S3	e	
ZEG	00	8.0	10.3	6.0	15.5	1.0	13.7	6.3	9.0	M7x0.5	●
ZEG	0B	10.0	12.5	7.0	20.7	1.2	19.1	8.2	11.0	M9x0.6	●
ZEG	1B	14.0	16.0	7.5	23.0	1.5	21.1	10.5	14.0	M12X1.0	●
ZEG	2B	18.0	19.5	8.5	26.7	1.8	24.6	13.5	17.0	M15x1.0	●
ZEG	3B	22.0	25.0	11.5	30.7	2.0	28.1	16.5	22.0	M18X1.0	●
ZEG	4B	28.0	34.0	12.0	35.7	2.5	34.1	23.5	30.0	M25X1.0	○

b series



Materials

Brass (chrome plated) shell and collet nut, nickel plated brass latch sleeve and mid pieces

Temperature range

-40°C / +200°C

Multicontact types 2 to 40 contacts

IP Index: IP50

ZEE

| b series

Fixed socket (panel mounting)

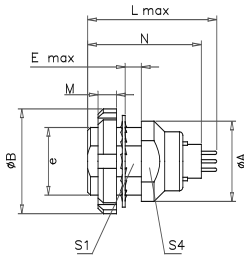

Reference		Dimensions (mm)									Availability
Model	Size	A	B	E	L	M	N	S1	S4	e	
ZEE	00	10.0	9.5	2.3	15.5	2.5	13.7	6.3	7.5	M7x0.5	○
ZEE	0B	12.0	12.5	2.4	20.7	2.5	19.1	8.2	9.0	M9x0.6	●
ZEE	1B	16.0	16.0	5.0	23.0	3.2	21.1	10.5	13.0	M12X1.0	●
ZEE	2B	20.0	20.0	4.5	26.7	3.5	24.6	13.5	15.0	M15x1.0	●
ZEE	3B	24.0	25.0	9.0	30.7	4.5	28.1	16.5	20.0	M18X1.0	●



Materials

Brass (chrome plated) shell and collet nut, nickel plated brass latch sleeve and mid pieces

Temperature range

-40°C / +200°C

Multicontact types 2 to 40 contacts

IP Index: IP50

ZEC

I b series

Fixed socket with two nuts (panel mounting)

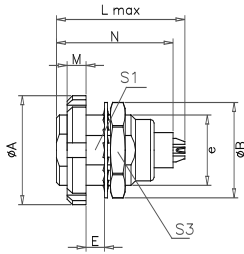

Reference		Dimensions (mm)									Availability
Model	Size	A	B	E	L	M	N	S1	S3	e	
ZEC	0B	12.0	12.5	5.5	20.7	2.5	19.1	8.2	11.0	M9x0.6	●
ZEC	1B	16.0	16.0	6.0	23.0	3.5	21.1	10.5	14.0	M12X1.0	●
ZEC	2B	20.0	19.5	6.5	26.7	3.5	24.6	13.5	17.0	M15x1.0	●
ZEC	3B	24.0	25.0	9.0	30.7	4.5	28.1	16.5	22.0	M18X1.0	●
ZEC	4B	30.0	32.0	10.0	35.7	4.5	32.6	23.5	30.0	M25X1.0	○

b series



Materials

Brass (chrome plated) shell and collet nut, nickel plated brass latch sleeve and mid pieces

Temperature range

-40°C / +200°C

Multicontact types 2 to 40 contacts

IP Index: IP50

ZEG

I b series

Fixed socket with two nuts, with elbow (90°) contact for printed circuit (panel mounting)

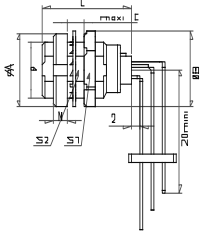

Reference		Dimensions (mm)								Availability
Model	Size	A	B	E	L	M	S1	S2	e	
ZEG	0B	12.0	12.5	2.4	18.3	2.5	8.2	11.0	M9x0.6	●
ZEG	1B	16.0	16.0	6.0	20.3	3.5	10.5	14.0	M12X1.0	●
ZEG	2B	20.0	19.5	6.0	22.3	3.5	13.5	17.0	M15x1.0	○
ZEG	3B	24.0	25.5	9.0	25.8	4.5	16.5	22.0	M18X1.0	○



Materials

Brass (chrome plated) shell and collet nut, nickel plated brass latch sleeve and mid pieces

Temperature range

-40°C / +200°C

Multicontact types 1 to 18 contacts

IP Index: IP50

b series

ZEZ

I b series

Straight socket for printed circuit

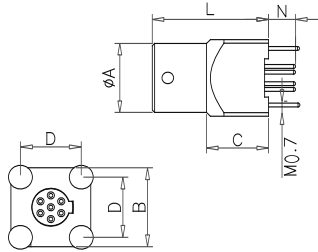

Reference		Dimensions (mm)					Availability	
Model	Size	A	B	C	D	L		
ZEZ	00	6.8	7.0	7.0	5.1	14.0	○	
ZEZ	0B	9.0	10.0	8.0	7.6	15.0	○	
ZEZ	1B	11.0	12.0	8.0	7.6	19.0	○	
ZEZ	2B	14.0	15.0	9.0	10.1	22.5	○	

b series

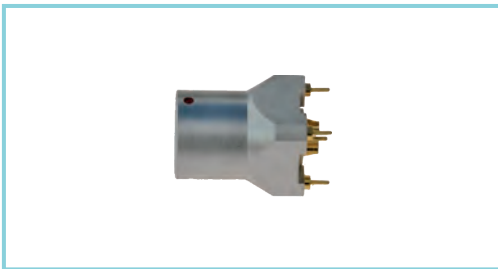

Materials

Brass (chrome plated) shell and collet nut, nickel plated brass latch sleeve and mid pieces

Temperature range

-40°C / +200°C

Multicontact types 2 to 40 contacts

IP Index: IP50

ZEZ

I b series

Straight socket for printed circuit

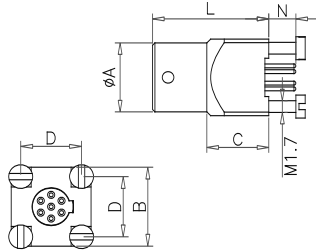

Reference		Dimensions (mm)						Availability	
Model	Size	A	B	C	D	L	N		
ZEZ	0B	9.0	10.0	8.0	7.6	15.0	4.5	○	
ZEZ	1B	11.0	12.0	8.0	7.6	19.0	4.5	○	
ZEZ	2B	14.0	15.0	9.0	10.1	22.5	5.5	○	

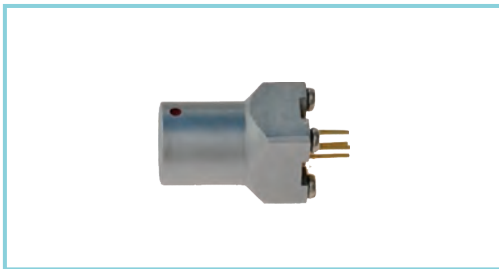

Materials

Brass (chrome plated) shell and collet nut, nickel plated brass latch sleeve and mid pieces

Temperature range

-40°C / +200°C

Multicontact types 2 to 40 contacts

IP Index: IP50

ZPH

I b series

Free socket with standard back nut

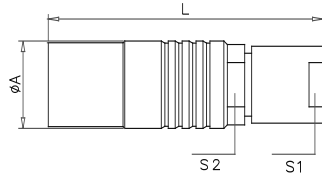

Reference		Dimensions (mm)				Availability	
Model	Size	A	L	S1	S2		
ZPH	00	6.8	26.0	5.5	5.0	○	
ZPH	0B	9.5	35.5	8.0	7.0	●	
ZPH	1B	12.5	40.5	10.0	9.0	●	
ZPH	2B	16.5	47.0	13.0	12.0	●	
ZPH	3B	19.0	56.0	15.0	14.0	●	
ZPH	4B	24.4	73.0	21.0	20.0	○	



Materials

Brass (chrome plated) shell and collet nut, nickel plated brass latch sleeve and mid pieces

Temperature range

-40°C / +200°C

Multicontact types 2 to 40 contacts

IP Index: IP50

ZPH

I b series

Free socket with back nut for fitting a bend relief

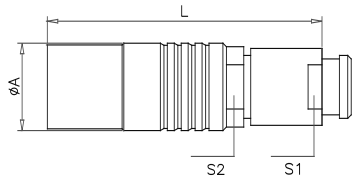

Reference		Dimensions (mm)				Availability	
Model	Size	A	L	S1	S2		
ZPH	00	6.8	26.0	5.5	5.0	○	
ZPH	0B	9.5	35.5	8.0	7.0	●	
ZPH	1B	12.5	40.5	10.0	9.0	●	
ZPH	2B	16.5	47.0	13.0	12.0	●	
ZPH	3B	19.0	56.0	15.0	14.0	●	
ZPH	4B	24.4	73.0	21.0	20.0	○	

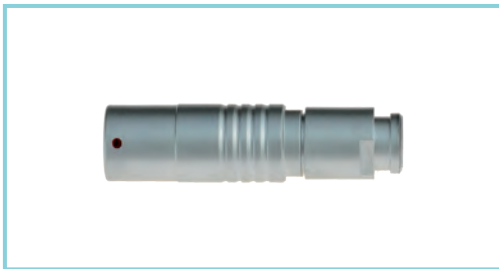

Materials

Brass (chrome plated) shell and collet nut, nickel plated brass latch sleeve and mid pieces

Temperature range

-40°C / +200°C

Multicontact types 2 to 40 contacts

IP Index: IP50

ZEP

I b series

Elbow (90°) socket for printed circuit

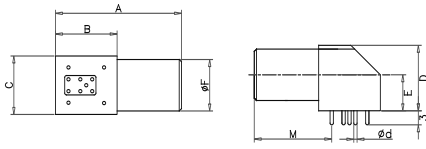

Reference		Dimensions (mm)								Availability	
Model	Size	A	B	C	D	E	F	M	d		
ZEP	0B	25.0	13.3	11.7	12.7	6.7	9.0	14.6	0.7	●	
ZEP	1B	27.0	13.3	12.6	14.0	7.5	11.0	16.0	0.7	●	

b series



Materials

Brass (chrome plated) shell and collet nut, nickel plated brass latch sleeve and mid pieces

Temperature range

-40°C / +200°C

Multicontact types 2 to 14 contacts

IP Index: IP50

ZEX

I b series

Elbow (90°) socket with two nuts for printed circuit (panel mounting)

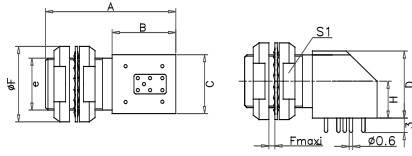

Reference		Dimensions (mm)									Availability
Model	Size	A	B	C	D	H	F	S1	E	e	
ZEX	0B	25.0	13.0	11.7	12.7	6.7	12.0	10.5	3.5	M9x0.5	●
ZEX	1B	27.0	13.3	12.6	14.0	7.5	14.0	12.0	5.0	M11x0.6	●



Materials

Brass (chrome plated) shell and collet nut, nickel plated brass latch sleeve and mid pieces

Temperature range

-40°C / +200°C

Multicontact types 2 to 14 contacts

IP Index: IP50

ZEP

I b series

Elbow (90°) socket for printed circuit

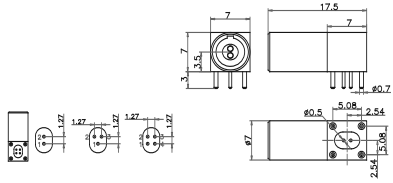

Note: all dimensions are in millimeters

Reference		Dimensions (mm)				Availability	
Model	Size						
ZEP	00	mm	mm	mm	mm	●	

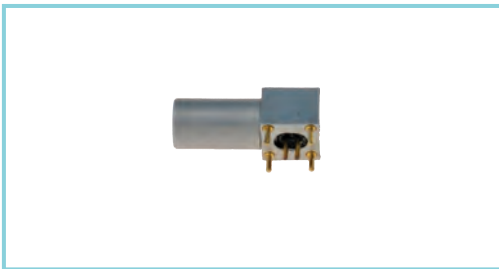

Materials

Brass (chrome plated) shell and collet nut, nickel plated brass latch sleeve and mid pieces

Temperature range

-40°C / +200°C

Multicontact types 1 to 18 contacts

IP Index: IP50

ZXB

I b series

Elbow (90°) socket with two nuts for printed circuit (panel mounting)

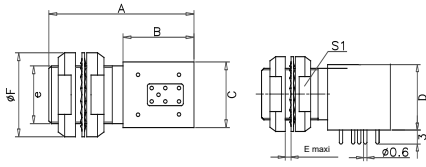

Reference		Dimensions (mm)								Availability
Model	Size	A	B	C	D	F	S1	E	e	
ZXB	0B	25	13	11.7	12.2	12.0	10.5	3.5	M9x0.5	●
ZXB	1B	27	13.3	12.6	13.2	14.0	12.0	5.0	M11x0.6	●



Materials

Brass (chrome plated) shell and collet nut, nickel plated brass latch sleeve and mid pieces

Temperature range

-40°C / +200°C

Multicontact types 2 to 14 contacts

IP Index: IP50

K SERIES CONNECTORS

TFG

| k series

Straight plug with standard back nut (IP68)

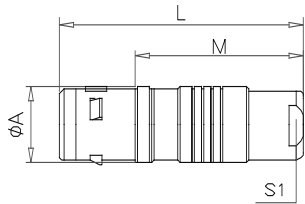

Reference		Dimensions (mm)				Availability	
Model	Size	A	L	M	S1		
TFG	0K	11.0	36.0	25.0	8.0	●	
TFG	1K	13.0	44.0	28.0	9.0	●	
TFG	2K	16.0	54.0	38.0	12.0	●	
TFG	3K	19.0	63.0	43.0	15.0	○	
TFG	4K	25.0	71.0	50.5	19.0	○	



Materials

Brass (chrome plated) shell and collet nut, nickel plated brass latch sleeve and mid pieces

Temperature range

-40°C / +200°C

Multicontact types 2 to 40 contacts

IP Index: IP68

TFG

| k series

Staight plug with back nut for fitting a bend relief (IP68)

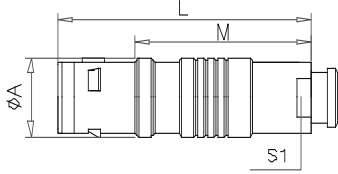

Reference		Dimensions (mm)				Availability	
Model	Size	A	L	M	S1		
TFG	0K	11.0	36.0	25.0	8.0	●	
TFG	1K	13.0	44.0	28.0	9.0	●	
TFG	2K	16.0	54.0	38.0	12.0	●	
TFG	3K	19.0	63.0	43.0	15.0	○	
TFG	4K	25.0	71.0	50.5	19.0	○	

k series



Materials

Brass (chrome plated) shell and collet nut, nickel plated brass latch sleeve and mid pieces

Temperature range

-40°C / +200°C

Multicontact types 2 to 40 contacts

IP Index: IP68

TFG

| k series

Straight plug with oversize back nut (IP68)

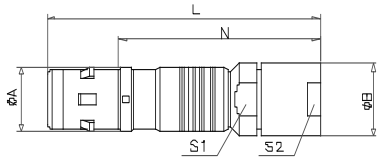

Reference		Dimensions (mm)						Availability	
Model	Size	A	B	L	N	S1	S2		
TFX	1K	13.0	14.5	55.0	41.0	12.0	12.0	●	
TFX	2K	16.0	17.0	65.0	49.0	15.0	15.0	○	
TFX	3K	19.0	22.0	80.0	60.0	19.0	19.0	○	
TFX	4K	25.0	36.0	107.0	86.0	30.0	32.0	○	

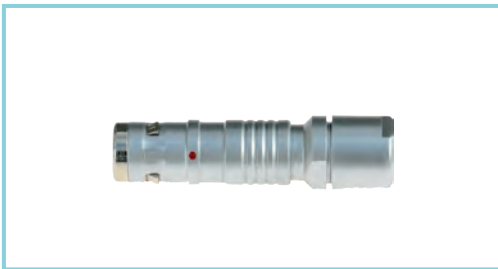

Materials

Brass (chrome plated) shell and collet nut, nickel plated brass latch sleeve and mid pieces

Temperature range

-40°C / +200°C

Multicontact types 2 to 40 contacts

IP Index: IP68

TFG

| k series

Straight plug with oversize back nut for fitting a bend relief (IP68)

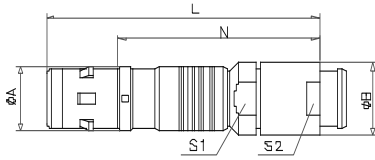

Reference		Dimensions (mm)						Availability	
Model	Size	A	B	L	N	S1	S2		
TFX	1K	13.0	14.5	55.0	41.0	12.0	12.0	●	
TFX	2K	16.0	17.0	65.0	49.0	15.0	15.0	○	
TFX	3K	19.0	22.0	80.0	60.0	19.0	19.0	○	
TFX	4K	25.0	36.0	107.0	86.0	30.0	32.0	○	

k series

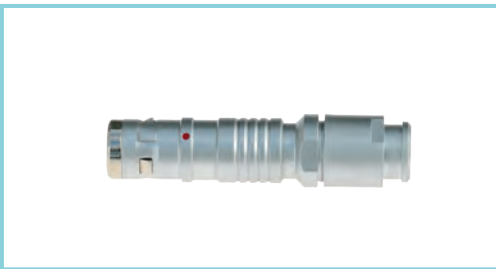

Materials

Brass (chrome plated) shell and collet nut, nickel plated brass latch sleeve and mid pieces

Temperature range

-40°C / +200°C

Multicontact types 2 to 40 contacts

IP Index: IP68

ZEG

| k series

Fixed socket (back panel mounting, IP68)

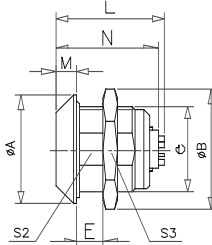

Reference		Dimensions (mm)									Availability
Model	Size	A	B	E	L	M	N	S2	S3	e	
ZEG	0K	18.0	19.5	6.0	21.7	4.0	20.1	12.5	17.0	M14x1.0	●
ZEG	1K	20.0	21.5	9.0	27.0	4.5	25.1	14.5	19.0	M16x1.0	●
ZEG	2K	25.0	27.5	9.0	30.7	5.0	28.6	18.5	24.0	M20x1.0	●
ZEG	3K	31.0	34.5	11.0	36.2	6.0	33.6	22.5	30.0	M24x1.0	○
ZEG	4K	37.0	40.5	10.0	40.2	6.5	38.6	28.5	36.0	M30x1.0	○



Materials

Brass (chrome plated) shell and collet nut, nickel plated brass latch sleeve and mid pieces

Temperature range

-40°C / +200°C

Multicontact types 2 to 40 contacts

IP Index: IP68

ZEE

I k series

Fixed socket (back panel mounting, IP68)

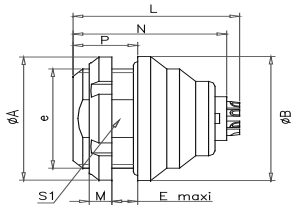

Reference		Dimensions (mm)									Availability
Model	Size	A	B	E	L	M	N	P	S1	e	
ZEE	0K	18.0	18.0	3.4	21.7	3.5	20.1	7.0	12.5	M14x1.0	●
ZEE	1K	20.0	20.0	6.2	27.0	3.5	25.1	10.0	14.5	M16x1.0	●
ZEE	2K	25.0	25.0	5.0	30.7	3.5	28.6	10.0	18.5	M20x1.0	●
ZEE	3K	30.0	31.0	7.5	36.2	4.5	33.6	12.0	22.5	M24x1.0	○
ZEE	4K	41.5	37.0	6.0	40.2	7.0	38.6	13.5	28.5	M30x1.0	○

k series



Materials

Brass (chrome plated) shell and collet nut, nickel plated brass latch sleeve and mid pieces

Temperature range

-40°C / +200°C

Multicontact types 2 to 40 contacts

IP Index: IP68

ZEH

| k series

Fixed socket, protruding shell (back panel mounting, IP68)

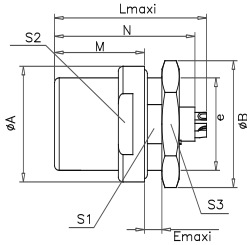

Reference		Dimensions (mm)										Availability
Model	Size	A	B	E	L	M	N	S1	S2	S3	e	
ZEH	0K	18.0	19.2	2.0	21.5	10.5	19.5	12.5	15.0	17.0	M14x1.0	●
ZEH	1K	20.0	21.5	2.0	26.5	15.5	24.5	14.5	17.0	19.0	M16x1.0	●
ZEH	2K	25.0	27.0	2.0	30.0	17.0	26.5	18.5	20.0	24.0	M20x1.0	○



Materials

Brass (chrome plated) shell and collet nut, nickel plated brass latch sleeve and mid pieces

Temperature range

-40°C / +200°C

Multicontact types 2 to 40 contacts

IP Index: IP68

ZPK

| k series

Fixed socket with cable collet and standard back nut (back panel mounting, IP68)

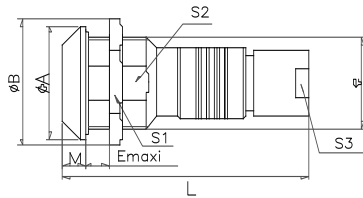

Reference		Dimensions (mm)									Availability
Model	Size	A	B	E	L	M	S1	S2	S3	e	
ZPK	0K	18.0	19.7	5.0	34.0	4.0	17.0	12.5	8.0	M14x1.0	●
ZPK	1K	20.0	21.9	8.0	45.0	4.5	19.0	14.5	9.0	M16x1.0	●
ZPK	2K	25.0	27.7	8.0	53.2	6.0	24.0	18.5	12.0	M20x1.0	○
ZPK	3K	31.0	34.0	10.0	65.0	6.0	30.0	22.5	15.0	M24x1.0	○

k series



Materials

Brass (chrome plated) shell and collet nut, nickel plated brass latch sleeve and mid pieces

Temperature range

-40°C / +200°C

Multicontact types 2 to 40 contacts

IP Index: IP68

ZPK

I k series

Fixed socket with cable collet and back nut for fitting a bend relief(back panel mounting, IP68)

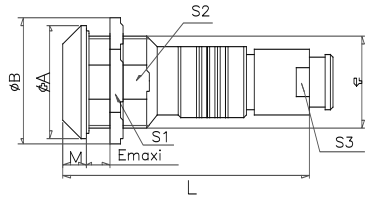

Reference		Dimensions (mm)									Availability
Model	Size	A	B	E	L	M	S1	S2	S3	e	
ZPK	0K	18.0	19.7	5.0	34.0	4.0	17.0	12.5	8.0	M14x1.0	●
ZPK	1K	20.0	21.9	8.0	45.0	4.5	19.0	14.5	9.0	M16x1.0	●
ZPK	2K	25.0	27.7	8.0	53.2	6.0	24.0	18.5	12.0	M20x1.0	○
ZPK	3K	31.0	34.0	10.0	65.0	6.0	30.0	22.5	15.0	M24x1.0	○

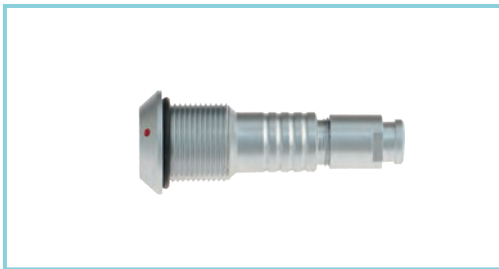

Materials

Brass (chrome plated) shell and collet nut, nickel plated brass latch sleeve and mid pieces

Temperature range

-40°C / +200°C

Multicontact types 2 to 40 contacts

IP Index: IP68

ZPH

| k series

Free socket with standard back nut (IP68)

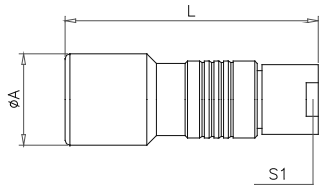

Reference		Dimensions (mm)			Availability	
Model	Size	A	L	S1		
ZPH	0K	13.0	34.0	8.0	●	
ZPH	1K	15.0	45.0	9.0	●	
ZPH	2K	19.0	54.0	12.0	●	
ZPH	3K	23.0	65.0	15.0	○	
ZPH	4K	29.0	75.5	19.0	○	

k series

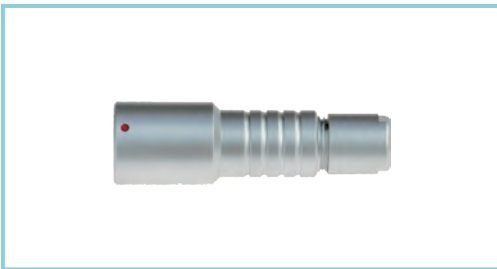

Materials

Brass (chrome plated) shell and collet nut, nickel plated brass latch sleeve and mid pieces

Temperature range

-40°C / +200°C

Multicontact types 2 to 40 contacts

IP Index: IP68

ZPH

I k series

Free socket with back nut for fitting a bend relief (IP68)

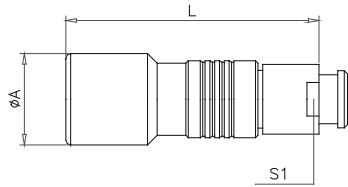

Reference		Dimensions (mm)			Availability	
Model	Size	A	L	S1		
ZPH	0K	13.0	34.0	8.0	●	
ZPH	1K	15.0	45.0	9.0	●	
ZPH	2K	19.0	54.0	12.0	●	
ZPH	3K	23.0	65.0	15.0	○	
ZPH	4K	29.0	75.5	19.0	○	

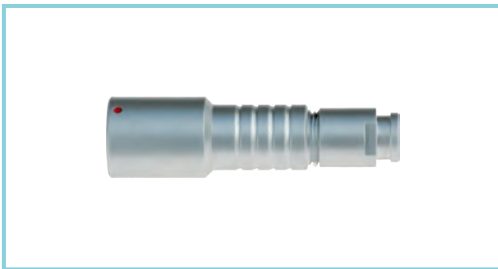

Materials

Brass (chrome plated) shell and collet nut, nickel plated brass latch sleeve and mid pieces

Temperature range

-40°C / +200°C

Multicontact types 2 to 40 contacts

IP Index: IP50

S SERIES CONNECTORS

TFF

| s series

Straight plug with standard back nut

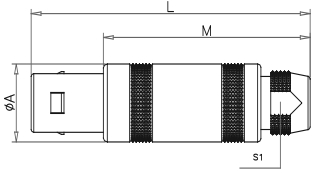

Reference		Dimensions (mm)				Availability	
Model	Size	A	L	M	S1		
TFF	00	6.4	26.0	18.0	4.5	●	
TFF	0S	9.0	34.5	24.5	6.5	●	
TFF	1S	12.0	42.5	31.5	8.5	●	
TFF	2S	14.8	52.0	40.0	11.0	○	
TFF	3S	17.8	61.0	46.0	14.0	○	



Materials

Brass (chrome plated) shell and collet nut, nickel plated brass latch sleeve and mid pieces

Temperature range

-40°C / +200°C

Multicontact types 1 to 18 contacts

IP Index: IP50

TFF

| s series

Straight plug with back nut for fitting a bend relief

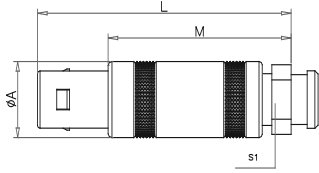

Reference		Dimensions (mm)				Availability	
Model	Size	A	L	M	S1		
TFF	00	6.4	26.0	18.0	4.5	●	
TFF	0S	9.0	34.5	24.5	6.5	●	
TFF	1S	12.0	42.5	31.5	8.5	●	
TFF	2S	14.8	52.0	40.0	11.0	○	
TFF	3S	17.8	61.0	46.0	14.0	○	

s series



Materials

Brass (chrome plated) shell and collet nut, nickel plated brass latch sleeve and mid pieces

Temperature range

-40°C / +200°C

Multicontact types 1 to 18 contacts

IP Index: IP50

ZER

I s series

Fixed socket (back panel mounting)

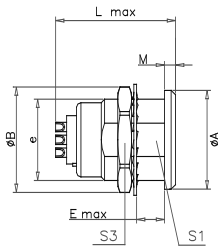

Reference		Dimensions (mm)									Availability
Model	Size	A	B	E	L	M	N	S1	S3	e	
ZER	00	8.0	10.3	5.5	14.5	1.0	12.7	6.3	9.0	M7x0.5	●
ZER	0S	10.0	12.5	7.0	17.5	1.2	16.0	8.2	11.0	M9x0.5	●
ZER	1S	14.0	16.0	7.5	20.2	1.5	18.3	10.5	14.0	M12x1.0	●
ZER	2S	18.0	19.5	8.5	24.5	1.8	22.4	13.5	17.0	M15x1.0	○
ZER	3S	22.0	25.2	11.5	29.0	2.0	26.1	16.5	22.0	M18x1.0	○



Materials

Brass (chrome plated) shell and collet nut, nickel plated brass latch sleeve and mid pieces

Temperature range

-40°C / +200°C

Multicontact types 1 to 18 contacts

IP Index: IP50

ZEE

I s series

Fixed socket with two nuts (panel mounting)

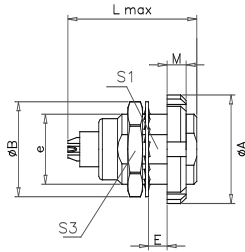

Reference		Dimensions (mm)									Availability
Model	Size	A	B	E	L	M	N	S1	S3	e	
ZEE	0S	12.0	12.5	5.5	17.5	2.5	16.0	8.2	11.0	M9x0.5	●
ZEE	1S	16.0	16.0	6.0	20.2	3.5	18.3	10.5	14.0	M12x1.0	●
ZEE	2S	20.0	19.5	6.5	24.5	3.5	22.4	13.5	17.0	M15x1.0	○
ZEE	3S	24.0	25.2	9.0	29.0	4.5	26.1	16.5	22.0	M18x1.0	○



Materials

Brass (chrome plated) shell and collet nut, nickel plated brass latch sleeve and mid pieces

Temperature range

-40°C / +200°C

Multicontact types 1 to 18 contacts

IP Index: IP50

ZPC

| s series

Free socket with standard back nut

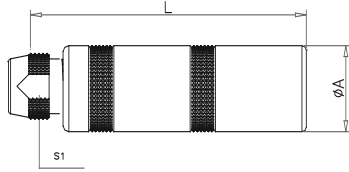

Reference		Dimensions (mm)			Availability	
Model	Size	A	L	S1		
ZPC	00	6.5	25.0	4.5	●	
ZPC	0S	8.9	33.5	6.5	●	
ZPC	1S	11.9	40.5	8.5	●	
ZPC	2S	14.8	50.5	11.0	○	
ZPC	3S	17.8	59.0	14.0	○	



Materials

Brass (chrome plated) shell and collet nut, nickel plated brass latch sleeve and mid pieces

Temperature range

-40°C / +200°C

Multicontact types 1 to 18 contacts

IP Index: IP50

ZPC

I s series

Free socket with back nut for fitting a bend relief

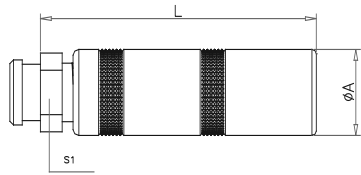

Reference		Dimensions (mm)			Availability	
Model	Size	A	L	S1		
ZPC	00	6.5	25.0	4.5	●	
ZPC	0S	8.9	33.5	6.5	●	
ZPC	1S	11.9	40.5	8.5	●	
ZPC	2S	14.8	50.5	11.0	○	
ZPC	3S	17.8	59.0	14.0	○	



Materials

Brass (chrome plated) shell and collet nut, nickel plated brass latch sleeve and mid pieces

Temperature range

-40°C / +200°C

Multicontact types 1 to 18 contacts

IP Index: IP50

B Series Multicontacts Layouts & Characteristics

	Male solder contact	Female solder contact	Reference	Number of contact	ø A (mm)	Solder wire max.(AWG)	R (max.)	Test voltage (V rms) Contact-contact	Test voltage (V rms) Contact-shell	Current rating (A)	Contact type availability		
											Solder	Printed circuit (straight)	Printed circuit (elbow)
00			02	2	0.5	30	10	1000	950	5.0	●	●	○
			03	3	0.5	30	10	800	950	3.0	●	●	○
			04	4	0.5	30	10	800	650	2.0	●	●	○
0B			02	2	0.9	24	6	1300	1050	10.0	●	●	○
			03	3	0.9	24	6	1200	900	8.0	●	●	○
			04	4	0.7	26	7.5	850	700	7.0	●	●	○
			05	5	0.7	26	7.5	1000	700	6.5	●	●	○
			06	6	0.5	28	10	850	650	2.5	●	●	○
			07	7	0.5	28	10	800	700	2.5	●	●	○
			09	9	0.5	28	10	600	500	2.0	●	●	○

Stranding values are in brackets. For a given AWG, the diameter of some stranded conductor designs could exceptionally be larger than the hole diameter of the barrel. Testing may be required.

Nominal Voltage acc. SAE AS 13441:1998 method 3001.1 meet the MIL-STD 1344, method 3001, Test acc. IEC 60512 test 4a.

B Series Multicontacts Layouts & Characteristics

B & K

	Male solder contact	Female solder contact	Reference	Number of contact	ø A (mm)	Solder wire max.(AWG)	R (max.)	Test voltage (V rms) Contact-contact	Test voltage (V rms) Contact-shell	Current rating (A)	Contact type availability		
											Solder	Printed circuit (straight)	Printed circuit (elbow)
1B			02	2	1.3	20	5	1500	1350	15.0	●	●	○
			03	3	1.3	20	5	1300	1550	12.0	●	●	○
			04	4	0.9	24	6	1350	1450	10.0	●	●	○
			05	5	0.9	24	6	1250	1150	9.0	●	●	○
			06	6	0.7	26	7.5	1050	1200	7.0	●	●	○
			07	7	0.7	26	7.5	950	1050	7.0	●	●	○
			08	8	0.7	26	7.5	950	1150	5.0	●	●	○
			10	10	0.5	28	10	900	1500	2.5	●	●	○
			14	14	0.5	28	10	800	1200	2.0	●	●	○

Stranding values are in brackets. For a given AWG, the diameter of some stranded conductor designs could exceptionally be larger than the hole diameter of the barrel. Testing may be required.

Nominal Voltage acc. SAE AS 13441:1998 method 3001.1 meet the MIL-STD 1344, method 3001, Test acc. IEC 60512 test 4a.

B Series Multicontacts Layouts & Characteristics

	Male solder contact	Female solder contact	Reference	Number of contact	ø A (mm)	Solder wire max. (AWG)	R (max.)	Test voltage (V rms) Contact-contact	Test voltage (V rms) Contact-shell	Current rating (A)	Contact type availability		
											Solder	Printed circuit (straight)	Printed circuit (elbow)
2B			02	2	2.0	16	3	2100	1750	30.0	●	●	○
			03	3	1.6	18	4	2400	1850	17.0	●	●	○
			04	4	1.3	20	5	1850	1850	15.0	●	●	○
			05	5	1.3	20	5	1750	1600	14.0	●	●	○
			06	6	1.3	20	5	1350	1450	12.0	●	●	○
			07	7	1.3	20	5	1750	1600	11.0	●	●	○
			08	8	0.9	24	6	1500	1250	10.0	●	●	○
			10	10	0.9	24	6	1450	1300	8.0	●	●	○
			12	12	0.7	26	7.5	1250	1350	7.0	●	●	○
			14	14	0.7	26	7.5	1150	1350	6.5	●	●	○
			16	16	0.7	26	7.5	950	1250	6.0	●	●	○
			18	18	0.7	26	7.5	850	1200	5.5	●	●	○
			19	19	0.7	26	7.5	950	1250	5.0	●	●	○
			26	26	0.5	28	10	950	1300	2.0	●	●	○

Stranding values are in brackets. For a given AWG, the diameter of some stranded conductor designs could exceptionally be larger than the hole diameter of the barrel. Testing may be required.

Nominal Voltage acc. SAE AS 13441:1998 method 3001.1 meet the MIL-STD 1344, method 3001, Test acc. IEC 60512 test 4a.

B K Series Multicontacts Layouts & Characteristics

	Male solder contact	Female solder contact	Reference	Number of contact	ø A (mm)	Solder wire max.(AWG)	R (max.)	Test voltage (V rms) Contact-contact	Test voltage (V rms) Contact-shell	Current rating (A)	Contact type availability		
											Solder	Printed circuit (straight)	Printed circuit (elbow)
3B / 3K			02	2	3.0	10	2	2100	1550	35.0	○	○	○
			03	3	2.0	16	3	1900	1500	25.0	○	○	○
			04	4	2.0	16	3	1450	1250	19.0	○	○	○
			05	5	1.6	18	4	1900	1250	19.0	○	○	○
			06	6	1.6	18	4	1600	1150	17.0	○	○	○
			07	7	1.6	18	4	1700	1250	15.0	○	○	○
			08	8	1.3	20	5	1650	1150	13.0	○	○	○
			10	10	1.3	20	5	1250	900	12.0	●	○	○
			12	12	0.9	24	6	1450	1000	9.0	●	○	○
			14	14	0.9	24	6	1200	1200	9.0	○	○	○
			16	16	0.9	24	6	1200	850	8.0	○	○	○
			18	18	0.9	24	6	1200	1050	7.0	●	○	○
			20	20	0.7	26	7.5	1000	900	6.0	○	○	○
			22	22	0.7	26	7.5	1000	900	5.5	○	○	○

Stranding values are in brackets. For a given AWG, the diameter of some stranded conductor designs could exceptionally be larger than the hole diameter of the barrel. Testing may be required.

Nominal Voltage acc. SAE AS 13441:1998 method 3001.1 meet the MIL-STD 1344, method 3001, Test acc. IEC 60512 test 4a.

B K Series Multicontacts Layouts & Characteristics

	Male solder contact	Female solder contact	Reference	Number of contact	ø A (mm)	Solder wire max. (AWG)	R (max.)	Test voltage (V rms) Contact-contact	Test voltage (V rms) Contact-shell	Current rating (A)	Contact type availability		
											Solder	Printed circuit (straight)	Printed circuit (elbow)
3B / 3K			24	24	0.7	26	7.5	950	800	4.0	○	○	○
			26	26	0.7	26	7.5	950	700	4.0	●	○	○
4B/4K			04	4	3.0	10	2	2100	1500	30.0	○	○	○
			06	6	2.0	16	3	2000	1750	24.0	○	○	○
			07	7	2.0	16	3	2000	1800	20.0	○	○	○
			10	10	1.6	18	4	1850	1300	17.0	○	○	○
			12	12	1.3	20	5	1450	1600	12.0	○	○	○
			16	16	0.9	24	6	1350	1500	10.0	○	○	○
			20	20	0.9	24	6	1350	1000	8.0	○	○	○
			24	24	0.9	24	6	1200	1450	7.0	○	○	○
			30	30	0.9	24	6	950	850	5.0	○	○	○
			40	40	0.7	26	7.5	900	950	2.0	○	○	○
			48	48	0.7	26	7.5	700	700	1.5	○	○	○

Stranding values are in brackets. For a given AWG, the diameter of some stranded conductor designs could exceptionally be larger than the hole diameter of the barrel. Testing may be required.

Nominal Voltage acc. SAE AS 13441:1998 method 3001.1 meet the MIL-STD 1344, method 3001, Test acc. IEC 60512 test 4a.

S Series Multicontacts Layouts & Characteristics

	Male solder contact	Female solder contact	Reference	Number of contact	ø A (mm)	Solder wire max. (AWG)	Test voltage (V rms) Contact-contact	Test voltage (V rms) Contact-shell	Current rating (A)	Contact type availability		
										Solder	Printed circuit (straight)	Printed circuit (elbow)
0S			02	2	0.9	24	1500	2100	10.0	●	○	○
			03	3	0.9	24	1000	1500	7.0	●	○	○
			04	4	0.7	26	1000	1500	7.0	●	○	○
1S			02	2	1.3	20	1200	1800	15.0	●	○	○
			03	3	0.9	24	1200	1800	10.0	●	○	○
			04	4	0.9	24	1200	1800	10.0	●	○	○
			05	2 3	0.9 0.7	24 26	1500	2100	10.0 7.0	●	○	○
			06	6	0.7	26	1500	2100	7.0	●	○	○

Stranding values are in brackets. For a given AWG, the diameter of some stranded conductor designs could exceptionally be larger than the hole diameter of the barrel. Testing may be required.
 Nominal Voltage acc. SAE AS 13441:1998 method 3001.1 meet the MIL-STD 1344, method 3001, Test acc. IEC 60512 test 4a.

S Series Multicontacts Layouts & Characteristics

	Male solder contact	Female solder contact	Reference	Number of contact	ø A (mm)	Solder wire max. (AWG)	Test voltage (V rms) Contact-contact	Test voltage (V rms) Contact-shell	Current rating (A)	Contact type availability		
										Solder	Printed circuit (straight)	Printed circuit (elbow)
2S			02	2	1.6	18	1700	2400	20.0	●	○	○
			03	3	1.3	20	1500	2100	15.0	●	○	○
			04	4	1.3	20	1700	2400	15.0	●	○	○
			05	5	1.3	20	1500	2100	13.0	●	○	○
			06	6	1.3	20	1500	2100	12.0	●	○	○
			07	7	1.3 0.9	20 24	800	1200	12.0 9.0	●	○	○
			08	8	0.9	24	800	1200	9.0	●	○	○
			10	10	0.9	24	800	1200	7.0	●	○	○

Stranding values are in brackets. For a given AWG, the diameter of some stranded conductor designs could exceptionally be larger than the hole diameter of the barrel. Testing may be required.
Nominal Voltage acc. SAE AS 13441:1998 method 3001.1 meet the MIL-STD 1344, method 3001, Test acc. IEC 60512 test 4a.













S Series single contact Layouts & Characteristics

	Male solder contact	Female solder contact	Reference	Number of contact	ø A (mm)	Test voltage (V rms) Contact-contact	Test voltage (V rms) Contact-shell	Current rating (A)	Contact type availability		
									Solder	Printed circuit (straight)	Printed circuit (elbow)
00			0A	1	1.3	800	1200	8.0	●	○	○
0S			0A	1	1.6	1500	2100	12.0	●	○	○
1S			0A	1	2.0	1800	2700	18.0	●	○	○
			0A	1	3.0	1500	2100	25.0	●	○	○
2S			0A	1	3.0	2100	3000	30.0	●	○	○
			0A	1	4.0	1800	2400	40.0	●	○	○

Stranding values are in brackets. For a given AWG, the diameter of some stranded conductor designs could exceptionally be larger than the hole diameter of the barrel. Testing may be required.

Nominal Voltage acc. SAE AS 13441:1998 method 3001.1 meet the MIL-STD 1344, method 3001, Test acc. IEC 60512 test 4a.

S Series Coaxial contacts Layouts & Characteristics

	Male solder contact	Female solder contact	Reference	Impedance	VSWR (GHz)	AC (V)	DC (V)	Current rating (A)	Contact type availability		
									Solder	Printed circuit (straight)	Printed circuit (elbow)
00			0C	50	1.09 +.11f	2100	3000	4.0	●	○	○
0S			0C	50	1.02 +.25f	3000	4200	6.0	●	○	○
1S			0C	50	1.01 +.08f	3000	4200	12.0	●	○	○
			0T	75	1.02 +.08f	2400	3300	10.0	●	○	○
2S			0C	50	1.02 +.95f	3000	4200	15.0	●	○	○
			0T	75	1.02 +.03f	1500	2100	12.0	●	○	○

Stranding values are in brackets. For a given AWG, the diameter of some stranded conductor designs could exceptionally be larger than the hole diameter of the barrel. Testing may be required.

Nominal Voltage acc. SAE AS 13441:1998 method 3001.1 meet the MIL-STD 1344, method 3001, Test acc. IEC 60512 test 4a.

B Series Cable Collets

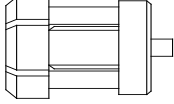
	Code	Cable ø (mm)		Availability						Part Number of Collet
		min.	max.	00	0B	1B	2B	3B	4B	
	20	1.5	2.0	●						
	25	2.0	2.5	●						
	30	2.5	3.0	●						
	35	3.0	3.5	●						
	30	2.0	3.0		●	●	○	○	○	
	40	3.0	4.0		●	●	●	○	○	
	50	4.0	5.0		●	●	●	●	○	
	60	5.0	6.0			●	●	●	○	
	70	6.0	7.0			●	●	●	○	
	80	7.0	8.0				●	●	○	
	90	8.0	9.0				●	●	○	
	02	9.0	10.0				○	●	○	

K Series Cable Collets

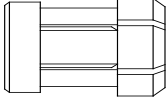
	Code	Cable ø (mm)		Availability						Part Number of Collet
		min.	max.	0K	1K	2K	3K	4K	5K	
	20	1.5	2.0	○						
	25	2.0	2.5	○						
	30	2.5	3.0	●	○					
	35	3.0	3.5	●	○					
	40	3.5	4.0	●	●	●	○	○	○	
	45	4.0	4.5	●	●	●	○	○	○	
	50	4.0	5.0	●	●	●	○	○	○	
	55	5.0	5.5		●	●	○	○	○	
	60	5.5	6.0		●	●	○	○	○	
	65	6.0	6.5		●	●	○	○	○	
	70	6.5	7.0		●	●	○	○	○	
	75	7.0	7.5		○	●	○	○	○	
	80	7.5	8.0			●	○	○	○	
	85	8.0	8.5				○	○	○	○
	90	8.5	9.0				○	○	○	○

S Series Cable Collets

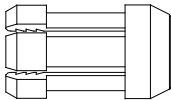

	Code	Cable \varnothing (mm)		Availability					Part Number of Collet		
		min.	max.	00	0S	1S	2S	3S			
	20	1.5	2.0	●							
	25	2.0	2.5	●							
	30	2.5	3.0	●							
	35	3.0	3.5	●							
	30	2.0	3.0		●	○	○	○			
	40	3.0	4.0		●	●	○	○			
	50	4.0	5.0		●	●	○	○			
	60	5.0	6.0			●	○	○			
	70	6.0	7.0			○	○	○			
	80	7.0	8.0				○	○			
	90	8.0	9.0					○	○		

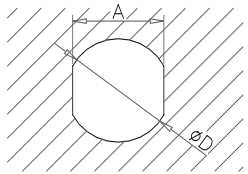
B K S F Series Panel Cut-Outs

	b series						k series				s seires					f series					
	00	0B	1B	2B	3B	4B	0K	1K	2K	3K	4K	00	0S	1S	2S	3S	0F	1F	2F	3F	4F
	A	6.4	8.3	10.6	13.6	16.6	23.6	12.6	14.6	18.6	22.6	28.6	6.4	8.3	10.6	13.6	16.6	8.3	10.1	12.1	14.2
D	7.1	9.1	12.1	15.1	18.2	25.2	14.1	16.1	20.2	24.2	30.2	7.1	9.1	12.1	15.1	18.2	9.1	12.1	14.1	15.1	18.1

Note: all dimensions are in millimeters

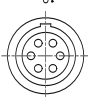
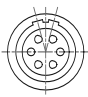
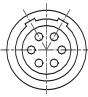
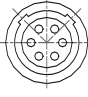
B K S F Series Coding

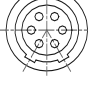
Front view of a receptacle	code	b series						k series				s seires					f series					
		00	0B	1B	2B	3B	4B	0K	1K	2K	3K	4K	00	0S	1S	2S	3S	0F	1F	2F	3F	4F
	0	●	●	●	●	●	●	●	●	●	●	○	○	○	○	○	●	●	●	●	●	
	A	○	●	●	●	○	○	○	○	○	○	○	○	○	○	○	○	○	○	○	○	○
	B	○	○	○	○	○	○	○	○	○	○	○	○	○	○	○	○	○	○	○	○	○
	D	○	○	○	○	○	○	○	○	○	○	○	○	○	○	○	○	○	○	○	○	○
	F	○	○	○	○	○	○	○	○	○	○	○	○	○	○	○	○	○	○	○	○	○
	J	○	○	○	○	○	○	○	○	○	○	○	○	○	○	○	○	○	○	○	○	○

PCB Drilling Patterns

Fixed socket with straight printed circuit contact (B & K series)

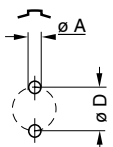
02	Size		Dimensions (mm)			Number of pole
	b series	k series	A	D	E°	
	00		0.6	1.2		2
	0B	0K	0.8	2.2		2
	1B	1K	0.8	2.8		2
	2B	2K	0.8	4.4		2

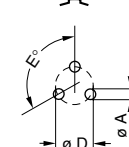
03	Size		Dimensions (mm)			Number of pole
	b series	k series	A	D	E°	
	00		0.6	1.35	120	3
	0B	0K	0.8	2.3	120	3
	1B	1K	0.8	3.0	120	3
	2B	2K	0.8	4.6	120	3
	3B	3K	0.8	5.6	120	3

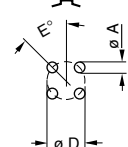
04	Size		Dimensions (mm)			Number of pole
	b series	k series	A	D	E°	
	00		0.6	1.6	45	4
	0B	0K	0.6	2.5	45	4
	1B	1K	0.8	3.1	45	4
	2B	2K	0.8	5.0	45	4
	3B	3K	0.8	6.2	45	4

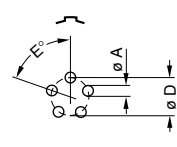
05	Size		Dimensions (mm)			Number of pole
	b series	k series	A	D	E°	
	0B	0K	0.6	2.8	72	5
	1B	1K	0.8	3.4	72	5
	2B	2K	0.8	5.2	72	5

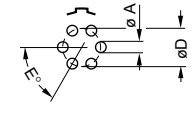
06	Size		Dimensions (mm)			Number of pole
	b series	k series	A	D	E°	
	0B	0K	0.6	3.0	60	6
	1B	1K	0.8	3.7	60	6

06	Size		Dimensions (mm)			Number of pole
	b series	k series	A	D	E°	
2B	2K	0.8	5.6	72	6	

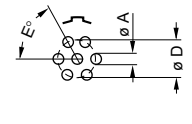
07	Size		Dimensions (mm)			Number of pole
	b series	k series	A	D	E°	
	0B	0K	0.6	3.0	60	7
	1B	1K	0.8	3.7	60	7
	2B	2K	0.8	5.8	60	

08	Size		Dimensions (mm)			Number of pole
	b series	k series	A	D	E°	
1B	1K	0.8	3.8	51.26	8	

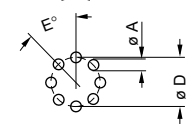
08	Size		Dimensions (mm)			Number of pole
	b series	k series	A	D	E°	
	2B	2K	0.8	6.4	45	8
	3B	3K	0.8	7.5	45	8

09	Size		Dimensions (mm)			Number of pole
	b series	k series	A	D	E°	
3B	3K	0.8	7.5	45	9	

Note: All views are from the side of the receptacle.

PCB Drilling Patterns

Fixed socket with straight printed circuit contact (B & K series)

10	Size		Dimensions (mm)				Number of pole	
	B	K	A	D	E	F		N
	1B	1K	0.6	3.95	45	22.3	1.4	10
	2B	2K	0.8	6.2	45	22.3	2.5	10
	3B	3K	0.8	7.9	45	22.3	2.8	10

12	Size		Dimensions (mm)				Number of pole	
	B	K	A	D	E	F		N
	2B	2K	0.8	6.5	45	22.3	2.8	12
	3B	3K	0.8	8.2	45	22.3	3.4	12

14	Size		Dimensions (mm)				Number of pole	
	B	K	A	D	E	N		M
	1B	1K	0.6	4.4	90	1.9	1.8	14
	2B	2K	0.8	6.5	90	2.65	2.65	14
	3B	3K	0.8	8.2	90	3.4	3.4	14

16	Size		Dimensions (mm)				Number of pole
	B	K	A	D	E	N	
	1B	1K	0.6	4.4	32.44	2.0	
	2B	2K	0.8	6.6	32.44	3.1	
	3B	3K	0.8	8.4	32.44	3.86	

18	Size		Dimensions (mm)				Number of pole	
	B	K	A	D	E	F		N
	2B	2K	0.8	6.7	60	30	3.5	18
	3B	3K	0.8	8.4	60	30	4.34	18

19	Size		Dimensions (mm)				Number of pole	
	B	K	A	D	E	F		N
	2B	2K	0.8	6.7	60	30	3.5	19

Note: All views are from the side of the receptacle.

P SERIES CONNECTORS



PA

Straight plug with standard back nut

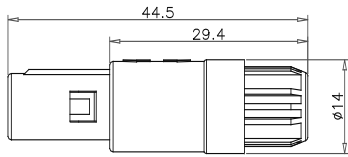

Note: all dimensions are in millimeters

Reference		Dimensions (mm)					Availability	
Model	Size							
PA	1P	mm	mm	mm	mm	mm	●	

P series



Materials

Polycarbonate (PC) or Polyarylsulfones (PSU) plastic shell and collet nut, housing available on grey, black and white color.

Temperature range

-40°C / +150°C

Multicontact types 2 to 14 contacts

IP Index: IP50 IP64

PF

Straight plug with back nut for fitting a bend relief(IP65 while overmoulding)

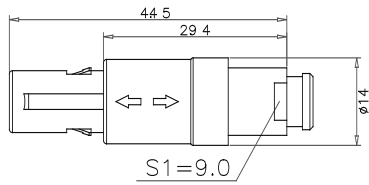

Note: all dimensions are in millimeters

Reference		Dimensions (mm)					Availability	
Model	Size	mm	mm	mm	mm	mm		
PF	1P						●	

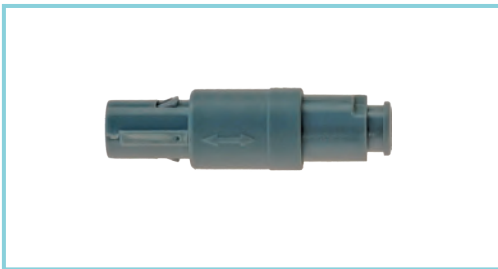

Materials

Polycarbonate (PC) or Polyarylsulfones (PSU) plastic shell and collet nut, housing available on grey, black and white color.

Temperature range

-40°C / +150°C

Multicontact types 2 to 14 contacts

IP Index: IP50 IP64

PJ

Straight plug with back nut for fitting a bend relief(IP65 while overmoulding)

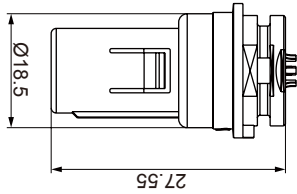

Note: all dimensions are in millimeters

Reference		Dimensions (mm)					Availability	
Model	Size							
PF	1P	mm	mm	mm	mm	mm	●	

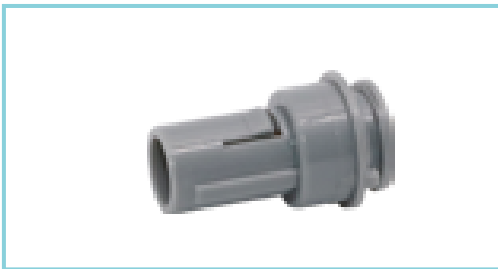

Materials

Polycarbonate (PC) or Polyarylsulfones (PSU) plastic shell and collet nut, housing available on grey, black and white color.

Temperature range

-40°C / +150°C

Multicontact types 2 to 14 contacts

IP Index: IP50 IP64

PK

Fixed socket with two nuts (back panel mounting)

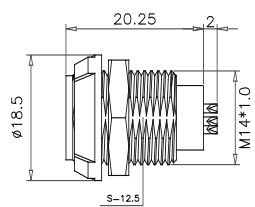

Note: all dimensions are in millimeters

Reference		Dimensions (mm)					Availability
Model	Size	mm	mm	mm	mm	mm	
PK	1P						●

P series



Materials

Polycarbonate (PC) or Polyarylsulfones (PSU) plastic shell and collet nut, housing available on grey, black and white color.

Temperature range

-40°C / +150°C

Multicontact types 2 to 14 contacts

IP Index: IP50

PN

Fixed socket with one nut (back panel mounting) IP65

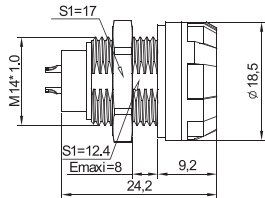

Note: all dimensions are in millimeters

Reference		Dimensions (mm)					Availability	
Model	Size	mm	mm	mm	mm	mm		
PN	1P						●	



Materials

Polycarbonate (PC) or Polyarylsulfones (PSU) plastic shell and collet nut, housing available on grey, black and white color.

Temperature range

-40°C / +150°C

Multicontact types 2 to 14 contacts

IP Index: IP50

PK

Fixed socket with two nuts, with 90° contacts (back panel mounting)

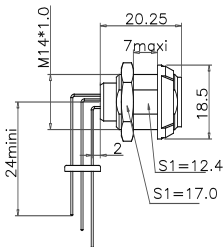

Note: all dimensions are in millimeters

Reference		Dimensions (mm)					Availability
Model	Size	mm	mm	mm	mm	mm	
P101	1P						●

P series

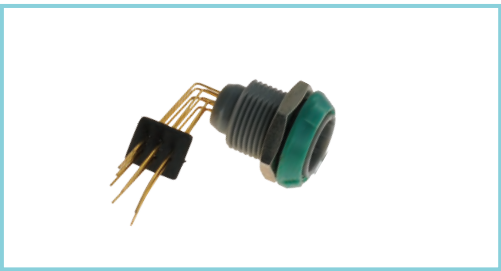

Materials
 Polycarbonate (PC) or Polyarylsulfones (PSU) plastic shell and collet nut, housing available on grey, black and white color.

Temperature range
 -40°C / +150°C

Multicontact types 2 to 14 contacts

IP Index: IP50

P Series





Multicontacts Layouts & Characteristics

	Male solder contact	Female solder contact	Reference	Number of contact	ø A (mm)	Solder wire max. (AWG)	R (max.)	Test voltage (V rms) Contact-contact	Current rating (A)	Contact type availability		
										Solder	Printed circuit (straight)	Printed circuit (elbow)
1P			02	2	1.3	20	5	1200	10.0	●	●	●
			03	3	1.3	20	5	1200	10.0	●	●	●
			04	4	0.9	24	6	1200	8.0	●	●	●
			05	5	0.9	24	6	1050	7.0	●	●	●
			06	6	0.7	26	7.5	1050	6.0	●	●	●
			07	7	0.7	26	7.5	1050	5.0	●	●	●
			08	8	0.7	26	7.5	1050	5.0	●	●	●
			09	9	0.5	28	10	850	3.0	●	●	●
			10	10	0.5	28	10	850	3.0	●	●	●
			14	14	0.5	28	10	600	2.0	●	●	●

Stranding values are in brackets. For a given AWG, the diameter of some stranded conductor designs could exceptionally be larger than the hole diameter of the barrel. Testing may be required.
Nominal Voltage acc. SAE AS 13441:1998 method 3001.1 meet the MIL-STD 1344, method 3001, Test acc. IEC 60512 test 4a.

* 2P 3P series is not show here, please contact our sale team for data sheet.

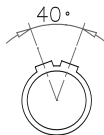
Alignment Key

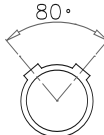
	0° 	40° 	60° 	80° 
Reference	0	4	6	8

Cable Collet

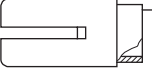
	Code	Cable ø (mm)		Availability	Part Number of Collet
		min.	max.		
	39	2.7	3.9	●	
	52	4.0	5.2	●	
	65	5.3	6.5	●	

Color Code

Color	Red	Blue	Yellow	Green	Grey	Black
Reference	R	A	Y	V	G	N

Bend relief



PCB Drilling Patterns

Fixed socket with straight printed circuit contact (1P series)

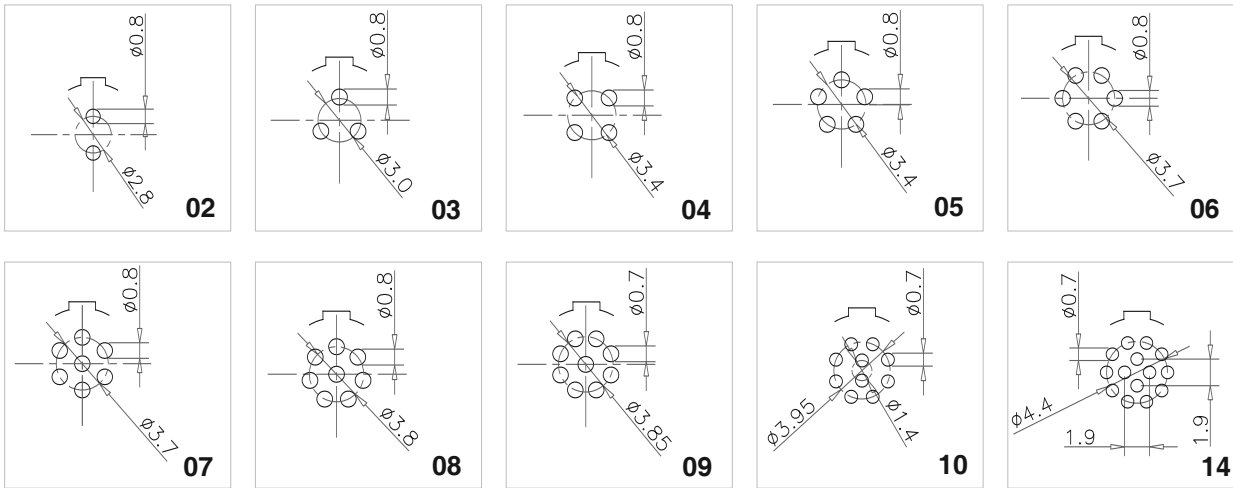

Note: All views are from the side of the receptacle, all dimensions are in millimeters

Panel Cut-Outs

	1 P series				
	A	12.5			
	D	14.0			

Note: all dimensions are in millimeters



Connecting to new technology



What your application is not listed here, we can build for you.

Product
CATALOG

Bexkom connector and cable systems

6 Floor, B unit, L building, Shifeng high-tech park,
Shuotai Road, Guangming District,
Shenzhen 518083
China

Tel: +86 755 23733680

Fax: +86 755 27397134

E-mail: cs1@bexkom.com

<https://www.bexkomconnectors.com>

